

COPPER CABLE TERMINALS : FORK TYPE (NON INSULATED)

Material : Electrolytic high conductivity-Copper
Finish : Electro Tinned Plated

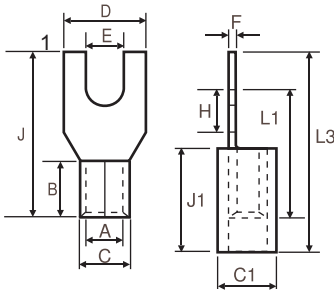

Product Ref. Non Insulated	Size mm ²	Stud Hole E	Dimensions mm										
			A	C	D	F	B	H	J	L1	C1	J1	L3
HGF-7214	1.5	5.1	1.6	1.6	8	0.8	5	10	21	17	4.8	10	27
HGF-7249		3.5	1.6	1.6	6.8	0.8	4	4.8	13	8.8	4.8	10	20.8
HGF-7250		3	2	2	6.2	0.4	5	3.1	13	10.5	4.8	10	20.5
HGF-7251	2.5	3.5	2.3	2.3	6.5	0.8	5	4.3	15	11.8	5.5	10	21.8
HGF - 7280		5	2.6	2.6	10.6	1.6	6.2	6.2	21	12.4	5.5	10	20
HGF-7252	4-6	3.1	3.5	3.5	6	1	6	5.5	15	11.5	7.1	14	27.5
HGF-7253		3.5	3.5	3.5	6	1	6	5	15	11	7.1	14	27
HGF-7254	10	6.5	4.5	4.5	16	1.2	8	11	27	19	7.9	16	35
HGF-7255		8.2	4.5	4.5	16	1.2	8	11	27	19	7.9	16	35

COPPER CABLE TERMINALS : FORK TYPE (INSULATED)

Material : E - Copper • Finish : Electro Tinned Plated
Colour Coding Of Insulation Sleeve
1.5 : Red, 2.5 : Blue, 4 - 6 : Yellow, 10 : Black



Product Ref. Insulated	Size mm ²	Stud Hole E	Dimensions mm										
			A	C	D	F	B	H	J	L1	C1	J1	L3
HGFI-7925	1.5	5.1	1.6	1.6	8	0.8	5	10	21	17	4.8	10	27
HGFI-7926		3.5	1.6	1.6	6.8	0.8	4	4.8	13	8.8	4.8	10	20.8
HGFI-7927		3	2	2	6.2	0.4	5	3.1	13	10.5	4.8	10	20.5
HGFI-7928	2.5	3.5	2.3	2.3	6.5	0.8	5	4.3	15	11.8	5.5	10	21.8
HGFI-7929		5	2.6	2.6	10.6	1.6	6.2	6.2	21	12.4	5.5	10	20
HGFI-7930	4-6	3.1	3.5	3.5	6	1	6	5.5	15	11.5	7.1	14	27.5
HFGI-7931		3.5	3.5	3.5	6	1	6	5	15	11	7.1	14	27
HGFI-7932	10	6.5	4.5	4.5	16	1.2	8	11	27	19	7.9	16	35
HFGI-7933		8.2	4.5	4.5	16	1.2	8	11	27	19	7.9	16	35

(All Dimensions in mm)